

Motorized Drapery Track System Silent Gliss® 5100

Installation

Ceiling Mount

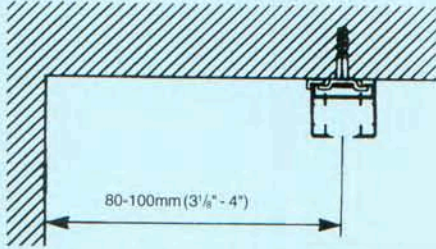

Swing clamp #3825 spaced approx. 60cm (24") o.c.

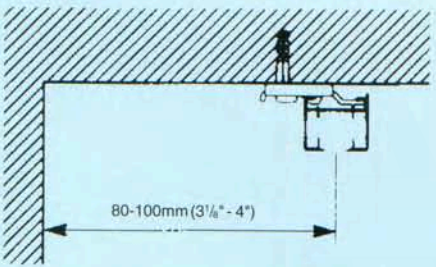

Bracket #3832 spaced approx. 60cm (24") o.c.

Wall Mount

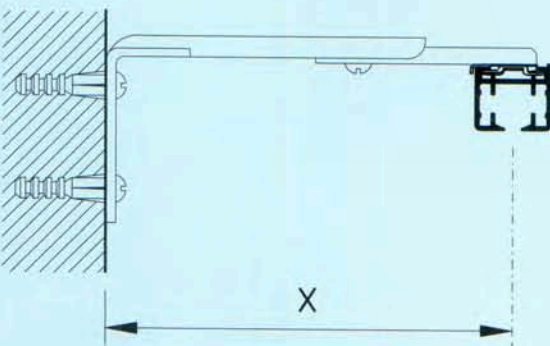

Wall mount with bracket #3832 and extension bracket #0829 or #0831

Bracket	X
#0829	N/A-64mm (N/A-2 1/2")
#0831	67-95mm (2 5/8 - 3 3/4")

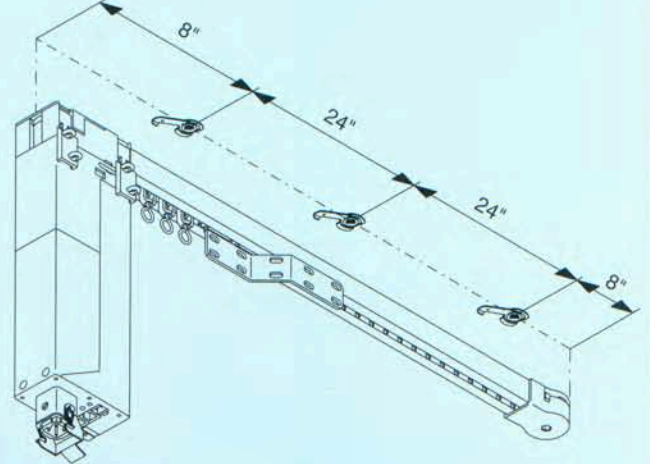

Recessed Mount

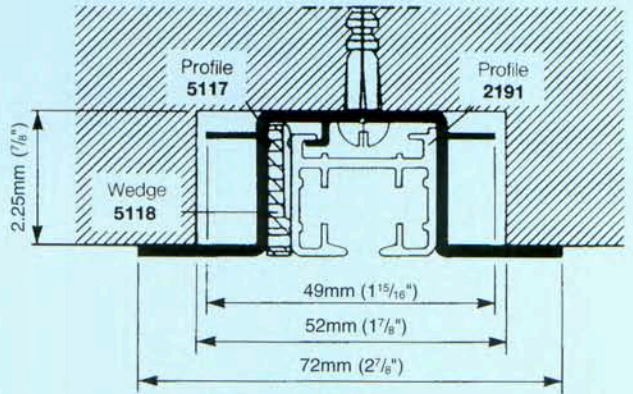

Profile recessed into ceiling with motor below rail or rail and motor recessed into ceiling



5114 Ceiling Cover plate



5118 Wedge

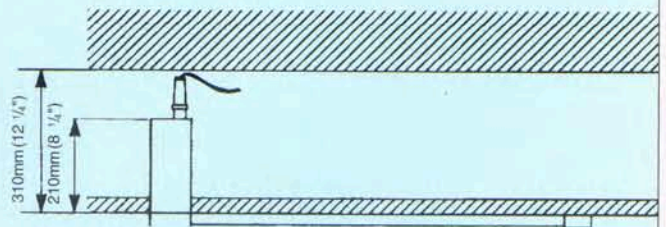

System ceiling mounted with motor recessed above

Motorized Drapery Track System Silent Gliss® 5100

Explosion Drawing

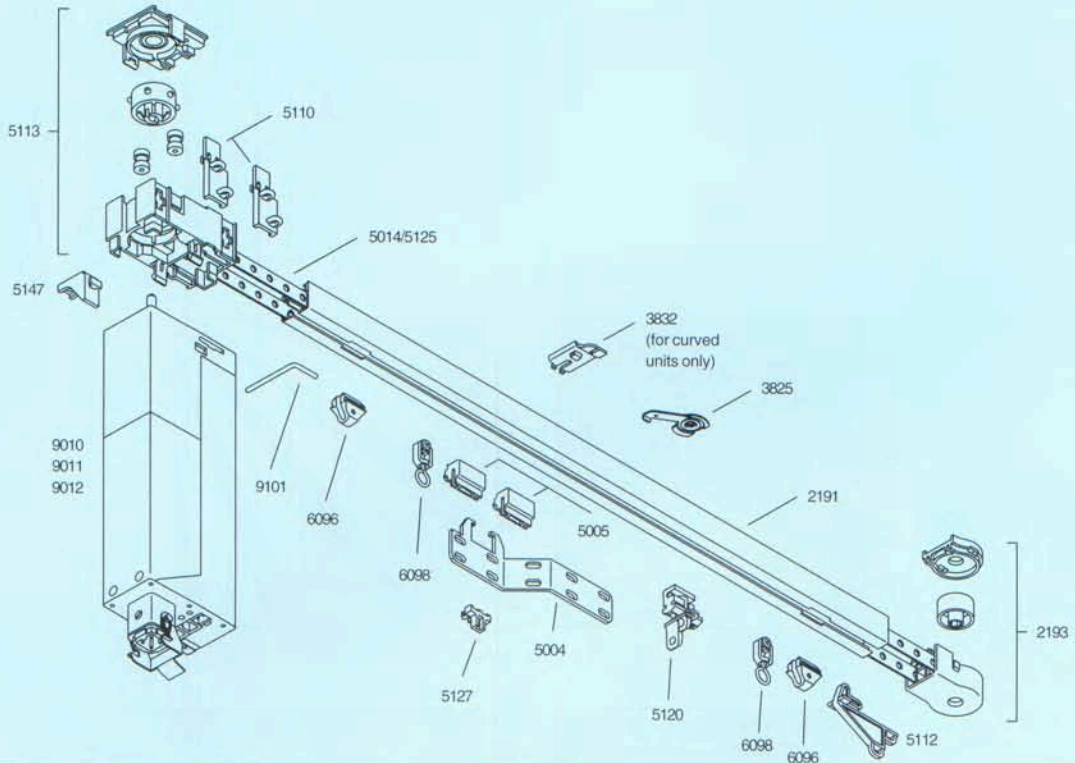

Standard Components

9111 Pulley Set

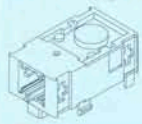

5113
Drive Pulley

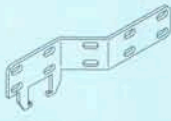

5004
Overlap



5127
Retainer Clip



9101
Motor Pin



5110
Mask (2X)



5125
Belt



3825
Mounting Bracket



5112
Return Mask

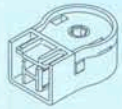

2193
Return Pulley



5005
Belt Connector



5120
Pilot (split draw)



5147
Support



6086
Spring Stop



6098
Roller

Optional Components

5115
Connecting Bridge

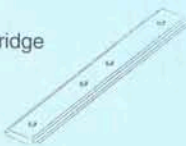

6094
Roller
with hook



0829
70mm (2³/₄")
Wall Extension
Bracket



5135
Crank



S-fold/Z-fold
components
refer to
section
"appendix"

3832
Bracket
for curved systems
and wall mount



0831
100mm (4.0")
Wall Extension
Bracket

