

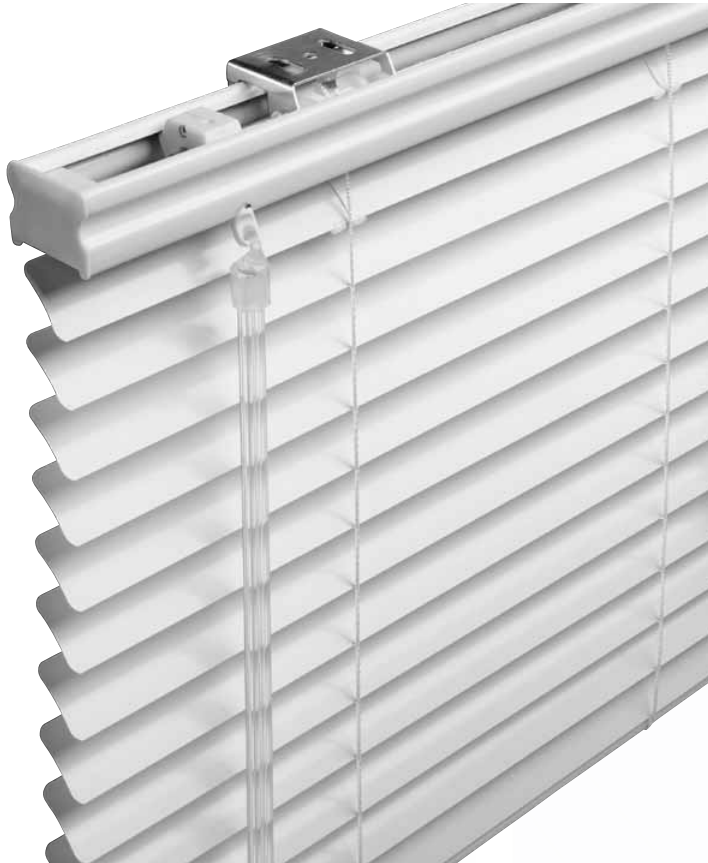

## Monaco<sup>®</sup> 6

Model #MON6

**Competitively positioned 1" horizontal aluminum window covering for commercial applications.**



### KEY FEATURES:

- Headrail: .94" high x 1.35" wide
- Nominal .006" slat thickness
- 21.5mm ladder spacing
- Limited lifetime warranty
- LightMaster™
- Integrated headrail
- Box brackets standard
- Integrated brackets available
- 90% recycled slat material

### PRODUCT OVERVIEW

The Monaco 6 1" Blind, considered the tenant standard, represents Levolor's competitively positioned horizontal blind backed by a lifetime limited warranty. Committed to both durability and aesthetics, the Monaco 6 1" blind provides the high quality economical choice.

The durable and slim headrail, made of roll-formed Tomized<sup>®</sup> steel, offers the choice of an integrated headrail or an add on valance.

The nominal .006" thick slats are made of 5000 series magnesium aluminum alloy which includes 90% or higher recycled aluminum material gauge. This material provides overall strength and resiliency, assuring a quality look for the life of the blind. The Monaco 6 1" blind's 21.5mm ladder spacing ensures tight closure and optimum light control.

# Monaco® 6 1" Blind

Box Brackets Standard  
Integrated Brackets Available

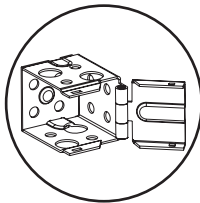
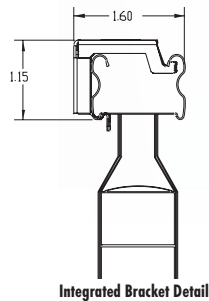
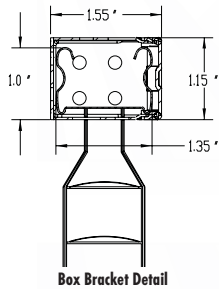

Open End Bracket

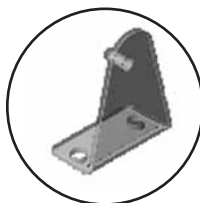

Hold-down Bracket

## PRODUCT SPECIFICATIONS

For more detailed specifications please reference Monaco 6 1" Blind product Guide Specifications.

### Part II - Products

#### A. Monaco 6 1" Blind manufactured by Levolor

#### B. Limited Lifetime Warranty

#### C. Materials:

- Headrail** shall be of .02" thick Tomized steel, .94" high x 1.35" wide. All hardware shall be enclosed in the metal headrail.
- Tilter** mechanism shall be a sealed polystyrene housing with lubricated worm and gear mechanism to prevent wear.
- Tilt Wand** shall be transparent with a round fluted cross section approximately 3/16" in diameter with 6 grooves for non-slip grip.
- Cord Lock** shall have steel shields with brass rollers and shall be crashproof.
- Drum and Cradle** shall be provided for each ladder. Drums and cradles shall be of engineering polymer.
- Installation Brackets** shall be of at least .035" thick painted steel with a hinged safety locking front cover to permit removal of headrail without lateral movement.
- Ladders** (slat supports): Distance between slats shall not exceed 21.5mm.
- Slats** shall be of 5000 series magnesium aluminum alloy which includes 90% or higher recycled aluminum materials. Slats shall be nominally 1" wide and the thickness of the slats shall be nominally .006".
- Bottomrail** shall be of .023" thick Tomized steel.
- Options** shall include:
  - a. Cord Cleat
  - b. End Mount Adapter
  - c. Extension Brackets
  - d. Hidden Brackets
  - e. Hold-Down Brackets
  - f. Integrated Bracket
  - g. LightMaster™
  - h. 2 Slat Framed Vogue® Valance



Levolor  
4110 Premier Drive  
High Point, NC 27265

© Copyright 2007 Levolor. All rights reserved. US and non-US patents and patents pending. Product specifications are subject to change without notice. Printed in the USA.

Contract Customer Service  
1-800-826-8021  
www.levolorcontract.com