



## *Advance* MULTIPLE MOUNT DISPLAYS

### Multiple Mount Displays for Every Application

- Available in 10' and 15' linear and radius displays as well as 60" diameter single piece or two-piece ring display.
- Ideal for use with Advance Quick-Link® Ceiling line of monitor mounts.
- Monitor mounts attach easily to display tube with MM-AB attachment brackets.

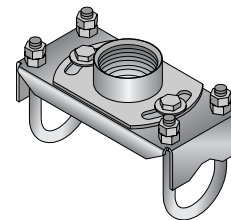

MM-C188

MM-AB  
Bracket

Model	Description	
MM-L120	120" Linear Pipe	x
MM-L180	180" Linear Pipe	x
MM-R120	120" Radius Pipe	x
MM-R180	180" Radius Pipe	x
MM-C188	60" Diameter Circular Ring Pipe	x
MM-C94	60" Diameter Circular Ring (split)	x
MM-AB	Attachment Bracket	x